

LEGEND

ROADS AND ROADWAY FEATURES	CONSERVATION AND RECREATION
<ul style="list-style-type: none"> Improved Road (Type A) Unimproved Road (Type B) Graded and Drained Road (Type C) Soil Surface Road (Type D) Gravel or Stone Road Not Graded or Drained (Type E-1) Gravel or Stone Road Graded and Drained (Type E-2) Gravel or Stone Road With Stabilized Surface (Type E-3) Bluminous Road—Low Type (Type F, G-1, H-1) Plowed Road (Type G-2, H-1, L, K, U) Divided Highway Highway With Full Control of Access Side Roads and Streets in Unincorporated Urban Campuses and Extensions of Local Roads Within Municipalities 4 Lane Undivided Highway Projected Road 	<ul style="list-style-type: none"> Public Ground Playground, Ball Field, Etc. Bathing Beach or Swimming Pool State Site Camp Site, No Permanence (Tents or Trailer Parking) Tented Camp or Motel (Figure indicates Number of Permanent Cabins or Cottages) Camp or Lodge (Permanence Site With Building) Small Park (SP State, CP County, MP Municipal (SP-Salary Real Acre)) Fish Hatchery Wild Sanctuary Game Farm Game Preserve Fish Club Golf Course or Country Club Rolling Academy Yacht Club Amusement Park or Hall Fair Ground, Race Course, Speedway Crown-in-Throne Marina Public Grounds Guest House or Gate House (Aid Letters N or S to Indicate National or State Park)
<ul style="list-style-type: none"> Federal-Aid Interstate Highway System Federal-Aid Primary Highway System Federal-Aid Secondary Highway System Federal-Aid Urban Highway System Points Between Which Distances are Measured Interstate Numbered Highway U. S. Numbered Highway State Highway System or State Numbered Highway End of Designated System or Marked Route 	<ul style="list-style-type: none"> Farm Unit Dwelling (Other Than Farm) Shed or Group of Dwellings Closely Spaced (Figure Denotes Number of Dwellings) Combined Dwelling and Store Dwelling and Post Office Dwelling, Business, and Filling Station Croft House Seasonal or Summer Colony Dwelling Hill, Inn Hemlock Society Quarters Church or Other Religious Institution Church and School (Joint Use) Cemetery Church With Cemetery Adjacent Fresh Air Farm or Rest Home Resort Wall State Port of Entry or Weight Station Group of Mixed Cultural Features Closely Spaced Figure above bar indicates number of dwellings included in the group. Figures over individual units show number of each included (regardless of order)
<ul style="list-style-type: none"> Railroad (Any Number of Tracks Used by a Single Operating Company or by Trains of Another Carrier Under Through Rights) Railroads in Juxtaposition (Two or More Tracks of Separately Operated Companies on Adjacent Rights-of-Way) Abandoned Railroads (Track Retained) Railroad Station 	<ul style="list-style-type: none"> FARM UNITS, DWELLINGS, ETC. INDUSTRIAL Shed or Small Business Establishment Business and Filing Station Business and Filing Station, and Post Office Factory or Industrial Plant Mine Shaft or Drift (Any Kind) Oil or Gas Well Oil or Gas Field Storage Tank (Gas or Oil Figure Denotes Number of Tanks) Filing Station (Not Connected With Other Business) Pumping Station (Oil or Gas) Gauging or Pumping Station (General) Vale House Seasonal Industry (Cannery or Small Grain Mill) Milk Depot, Creamery or Cheese Factory Fruit or Nut Orchard Fruit or Produce Packing House Road Stand Farm Products Sales Warehouse—General (If Government Aid State or U.S.) Grain Elevator Grain Storage Bin Greenhouse Nursery Stock Yard Loading Pen or Corral Stock Pen at Railroad Siding (Small) Quarry Quarry Over or Oven (Lime, Clay Products, Coke, Etc.) Feed Lot Shopping Center Seasonal Business Sam's (Stationery)
<ul style="list-style-type: none"> Grade Crossing Railroad Above Railroad Below Railroad Bridge 	<ul style="list-style-type: none"> STRUCTURES Highway Bridge, General Total Span Greater Than 20 Feet Small Bridges Closely Spaced Bridges For Long River Crossings General Arch Truss or Girder (in wood & steel) Cartwheel Bridge Highway Grate Miscellaneous Structures Levee Or Dam Levee Or Dam With Truss Concrete Food Or Dip Ford Road Established Cattle Guard Gate Across Road (Any Type)
<ul style="list-style-type: none"> Military Field (Some Facilities Available) Airport Complete Facilities (Commercial or Municipal) Airfield, Limited Facilities Landing Area or Strip (Including Private Air Fields) Airway Light Beacon, General Airport, General 	<ul style="list-style-type: none"> EDUCATIONAL AND CORRECTIONAL INSTITUTIONS Schoolhouse Consolidated or Large School Tenball, Grange, or Community Hall Agricultural Experiment Station Correctional Institution Museum—General Public Library
<ul style="list-style-type: none"> Grade Crossing Railroad Above Railroad Below Railroad Bridge 	<ul style="list-style-type: none"> BOUNDARIES State County Corporate Lines Boundary Lines Established For Delimited Urban Places Section Line Boundary to Mark Emargement Inlet Park and Other Reservations National, State, County, or Municipal Park, Indian Reservation, National Monument, Federal Development Project Monument—Small, Historic Site
<ul style="list-style-type: none"> Grade Crossing Railroad Above Railroad Below Railroad Bridge 	<ul style="list-style-type: none"> CITY AND VILLAGE CENTERS State Capital County Seat Other Cities and Villages Incorporated City or Village Boundary Lines "Ased" for Special Taxing Areas and Other Unincorporated Urban Places Delimited
<ul style="list-style-type: none"> Grade Crossing Railroad Above Railroad Below Railroad Bridge 	<ul style="list-style-type: none"> NATURAL FEATURES Prominent Elevation—With Name (Numerals Indicate Elevation Above Sea Level) Sink or Depression
<ul style="list-style-type: none"> Grade Crossing Railroad Above Railroad Below Railroad Bridge 	<ul style="list-style-type: none"> PUBLIC SERVICE FACILITIES Post Office Highway Garage Fire Engine House Garbage or Rubbish Dump Sanitary Disposal Plant Auto Salvage Yard Transformer Station Power Plant Power Substation Booster Station Water Supply, Stand Pipe, or Tank Radio Station (With Call Letters) Radio Station Radio Range Station Water Treatment Plant Jurisdiction U. S. Corps of Engineers Office
<ul style="list-style-type: none"> Grade Crossing Railroad Above Railroad Below Railroad Bridge 	<ul style="list-style-type: none"> MISCELLANEOUS Fort, Army Camp, Barracks, or Other Military Post Transpiration Station Bench Mark (With Elevation)

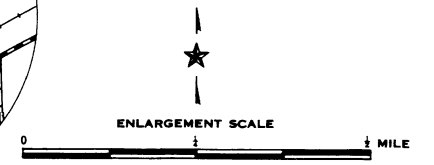
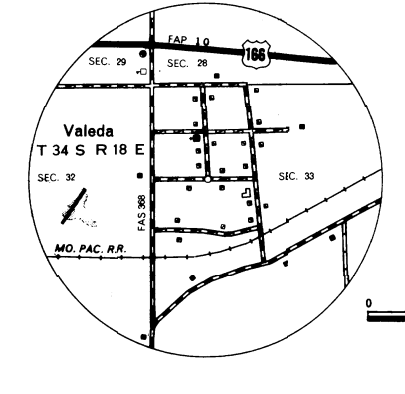
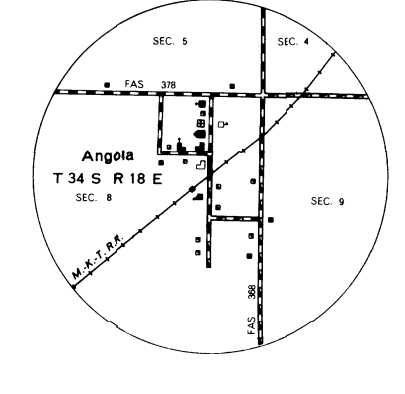
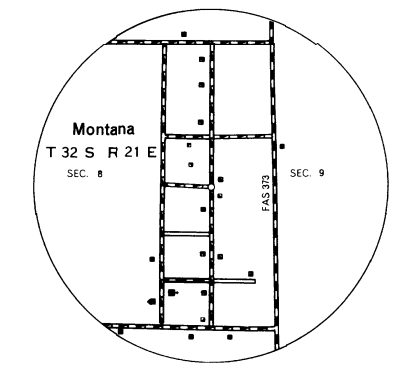
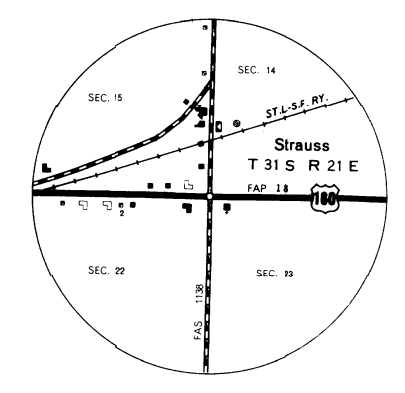
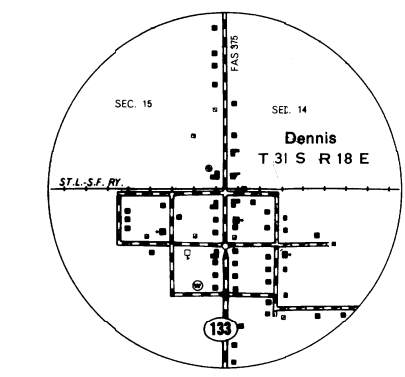
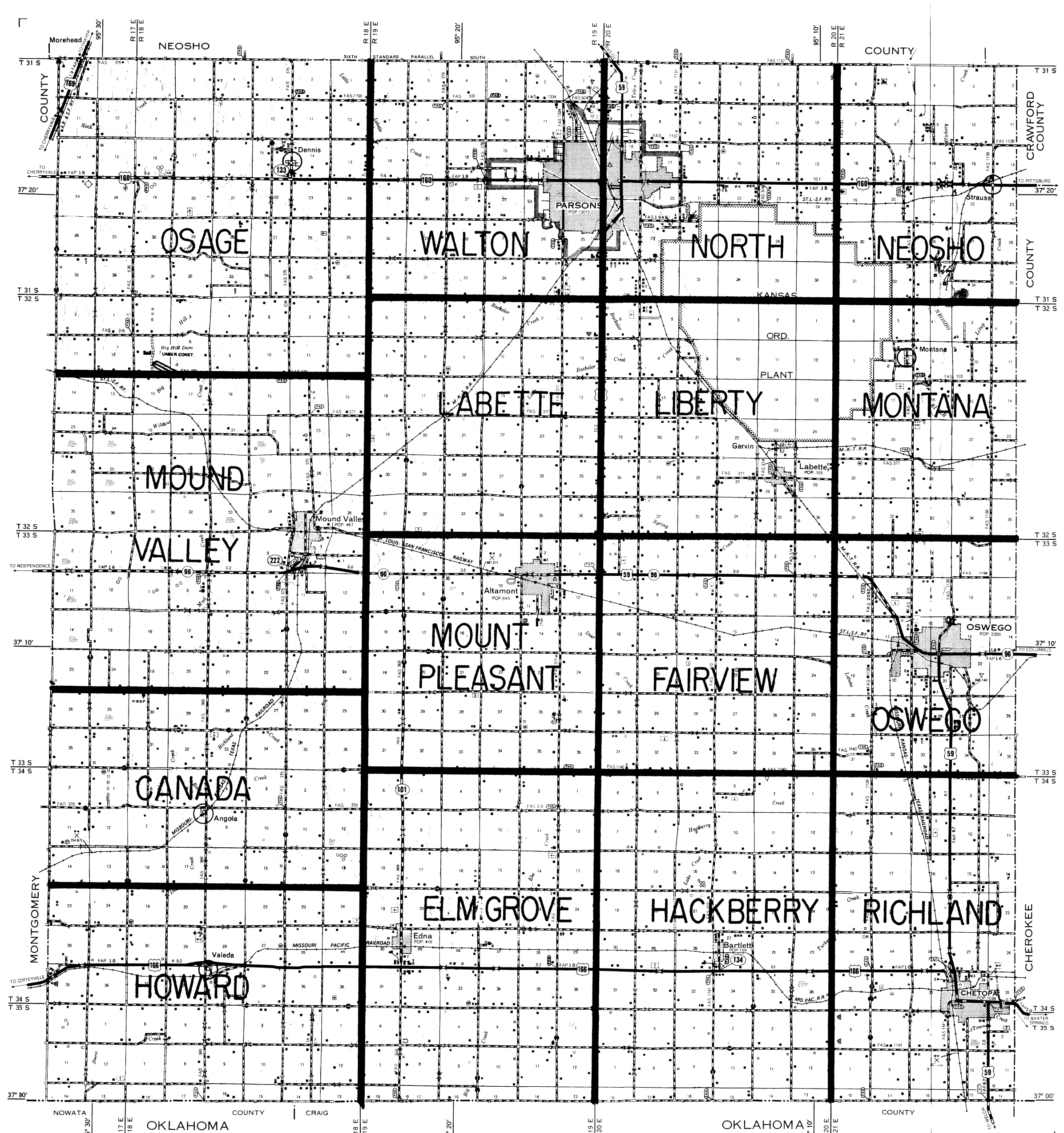

**GENERAL HIGHWAY MAP
LABETTE COUNTY
KANSAS**

PREPARED BY THE
KANSAS DEPARTMENT OF TRANSPORTATION
PLANNING AND DEVELOPMENT DEPARTMENT
IN COOPERATION WITH THE
U. S. DEPARTMENT OF TRANSPORTATION
FEDERAL HIGHWAY ADMINISTRATION

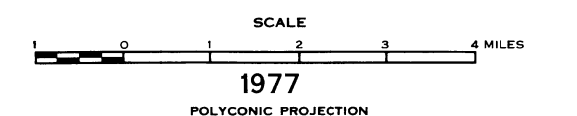

1977
POLYCONIC PROJECTION

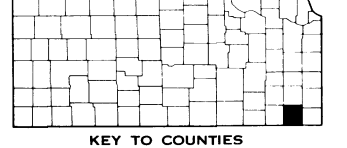

REINVENTORY COMPLETED
F. A. AND STATE
SYSTEM REVISED TO